

**Flanged “Y” type Strainer**  
**DN 15 - 200 PN16/40 & Class 150**  
 Cast Iron, Carbon Steel and Stainless Steel

**Index**



**Fig. S\_\_\_**

***Cast Iron: Fig. S116***

***Carbon Steel: Fig. S315 & S340***

***Stainless Steel: Fig. S415 & S416***

**CE**

Authorized Distributor

 **valcontrol**

**SERIES  
YCS**

# Flanged “Y” type strainer

## Parts and materials

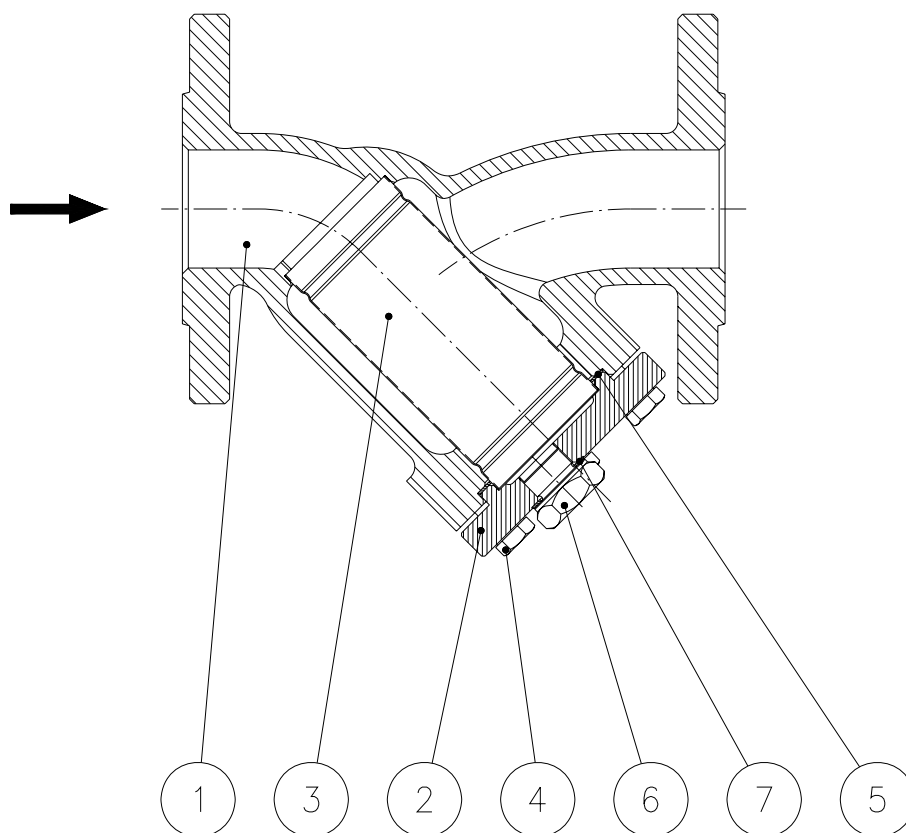

| ICP STRAINER |                   |            |                 |                 |
|--------------|-------------------|------------|-----------------|-----------------|
| Item         | Description       | Material   |                 |                 |
|              |                   | Cast Iron  | Carbon Steel    | Stainless Steel |
| 1            | Body              | EN-GJL-250 | 1.0619          | 1.4408          |
| 2            | Cap               | EN-GJL-250 | 1.0619          | 1.4408          |
| 3            | Strainer Screen   |            | 1.4301          |                 |
| 4            | Body Bolt         | 8.8        | 8.8             | A2              |
| 5            | Cap Gasket        |            | Synthetic Fiber | PTFE            |
| 6            | Drain Plug        |            | 1.0401          | 1.4401          |
| 7            | Drain Plug Gasket |            | Synthetic Fiber |                 |

(\*) Other materials under request.

# Flanged “Y” type strainer

## Dimensions

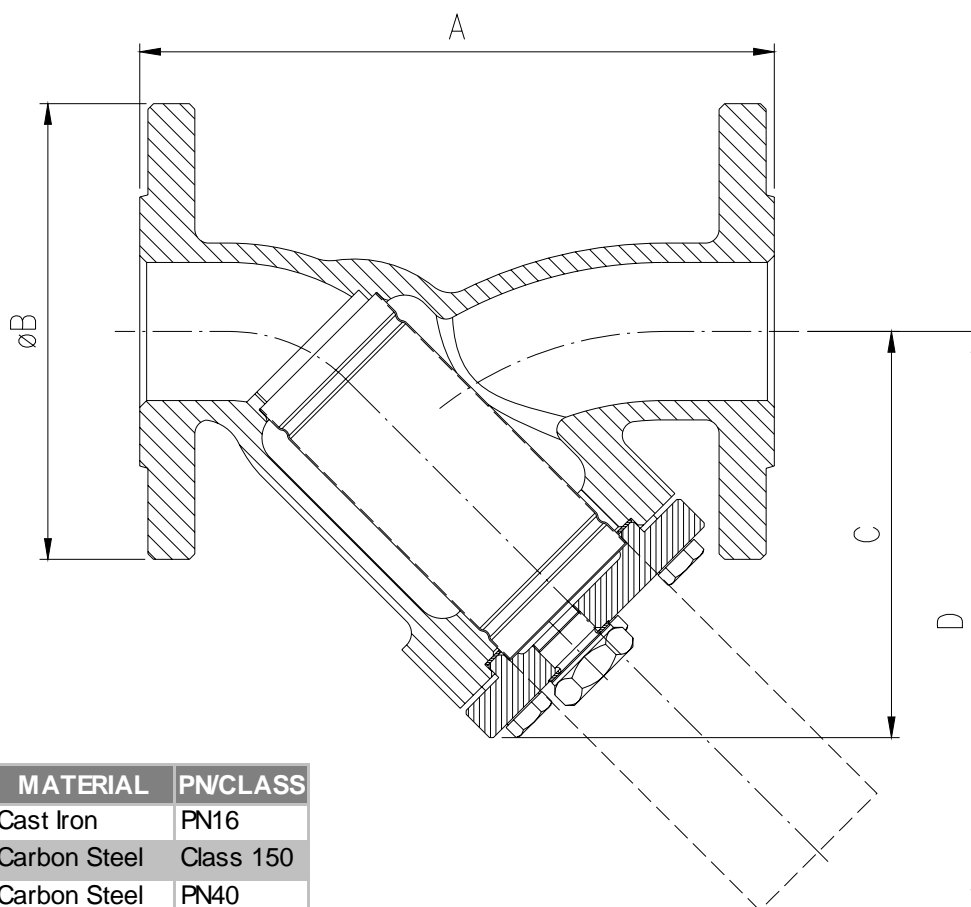

| FIG  | MATERIAL        | PN/CLASS  |
|------|-----------------|-----------|
| S116 | Cast Iron       | PN16      |
| S315 | Carbon Steel    | Class 150 |
| S340 | Carbon Steel    | PN40      |
| S415 | Stainless Steel | Class 150 |
| S416 | Stainless Steel | PN16      |

### General dimensions & Weight

| DN  | A   | C   | D   | S116 |        | S315 |        | S340 |        | S415 |        | S416 |        |
|-----|-----|-----|-----|------|--------|------|--------|------|--------|------|--------|------|--------|
|     |     |     |     | øB   | WEIGHT | øB   | WEIGHT | øB   | WEIGHT | øB   | WEIGHT | øB   | WEIGHT |
| 15  | 130 | 74  | 105 | 95   | 2,0    | 89   | 1,8    | 95   | 2,5    | 89   | 1,8    | 95   | 2,0    |
| 20  | 150 | 86  | 122 | 105  | 2,8    | 98,5 | 2,6    | 105  | 3,4    | 98,5 | 2,6    | 105  | 2,8    |
| 25  | 160 | 93  | 136 | 115  | 3,5    | 108  | 3,2    | 115  | 4,2    | 108  | 3,2    | 115  | 3,5    |
| 32  | 180 | 115 | 161 | 140  | 5,6    | 117  | 5,3    | 140  | 8,0    | 117  | 5,3    | 140  | 5,6    |
| 40  | 200 | 128 | 177 | 150  | 7,0    | 127  | 6,5    | 150  | 9,5    | 127  | 6,5    | 150  | 7,0    |
| 50  | 230 | 147 | 210 | 165  | 9,7    | 152  | 9,0    | 165  | 12,5   | 152  | 9,0    | 165  | 9,7    |
| 65  | 290 | 181 | 252 | 185  | 14,5   | 178  | 14,0   | 185  | 17,0   | 178  | 14,0   | 185  | 14,5   |
| 80  | 310 | 197 | 268 | 200  | 19,2   | 191  | 18,5   | 200  | 23,0   | 191  | 18,5   | 200  | 19,2   |
| 100 | 350 | 219 | 303 | 220  | 27,0   | 229  | 26,0   | 235  | 33,5   | 229  | 26,0   | 220  | 27,0   |
| 125 | 400 | 261 | 371 | 250  | 46,0   | 254  | 45,0   | 270  | 62,0   | 254  | 45,0   | 250  | 46,0   |
| 150 | 480 | 348 | 512 | 285  | 74,5   | 279  | 73,5   | 300  | 85,0   | 279  | 73,5   | 285  | 74,5   |
| 200 | 600 | 416 | 625 | 340  | 125,0  | 343  | 122,0  | 375  | 151,0  | 343  | 122,0  | 340  | 125,0  |

(\*) Dimensions in mm and weight in kg.

Authorized Distributor



**SERIES  
YCS**



# Flanged “Y” type strainer

## General Characteristics

|                                |                                   |  |  |
|--------------------------------|-----------------------------------|--|--|
| <b>GENERAL CHARACTERISTICS</b> | Fig.S116, S315, S340, S415 & S416 |  |  |
| <b>DESIGN STANDARDS</b>        |                                   |  |  |
| Valves design                  | DIN 3840                          |  |  |
| Face to face Dimensions        | EN 558 Series 1                   |  |  |
| Flanged Dimensions             | EN 1092 & ASME B16.5              |  |  |
| Visual Inspection              | MSS SP- 55                        |  |  |
| Marking                        | EN 19                             |  |  |
| <b>TESTS AND CERTIFICATES</b>  |                                   |  |  |
| Pressure testing               | EN 12266-1 P10                    |  |  |

### Strainer Screen Dimensions:

| DN  | øA  | B   | Perforation | Area    |
|-----|-----|-----|-------------|---------|
| 15  | 25  | 55  | ø1          | 1: 6,05 |
| 20  | 30  | 64  | ø1          | 1: 4,70 |
| 25  | 35  | 73  | ø1          | 1: 3,97 |
| 32  | 40  | 96  | ø1          | 1: 3,58 |
| 40  | 50  | 100 | ø1          | 1: 2,98 |
| 50  | 60  | 125 | ø1          | 1: 2,83 |
| 65  | 68  | 142 | ø1,5        | 1: 2,13 |
| 80  | 83  | 152 | ø1,5        | 1: 1,83 |
| 100 | 94  | 172 | ø1,5        | 1: 1,50 |
| 125 | 120 | 222 | ø1,5        | 1: 1,56 |
| 150 | 155 | 300 | ø1,5        | 1: 1,89 |
| 200 | 206 | 370 | ø1,5        | 1: 1,74 |

(\*) Dimensions in mm

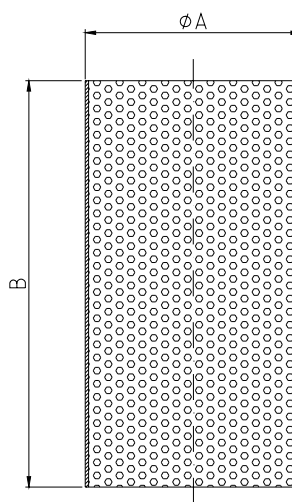

### Pressure Drop

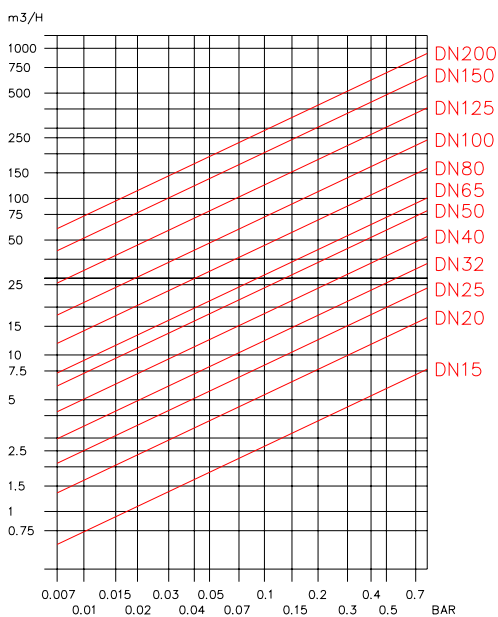

### Pressure-Temperature

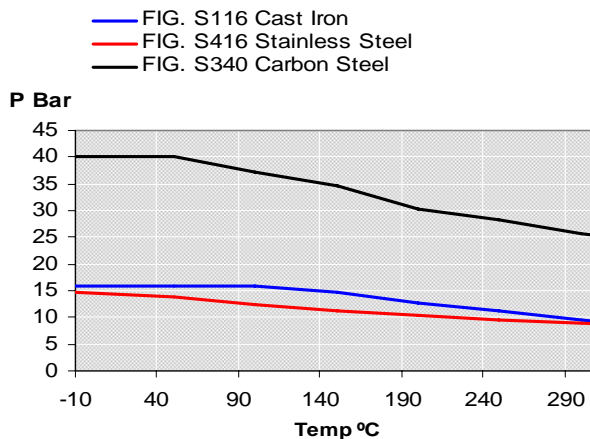

Authorized Distributor



**SERIES  
YCS**